

ELEVATION 118'-0"

RACK #	FUNCTION
1B	CTC-EE-431
2B	CTC-EE-432
3B	CTC-EE-433
4B	CTC-EE-434
5B	CTC-EE-435
6B	CTC-EE-419
7B	CTC-EE-436
8B	CTC-EE-437
9B	CTC-EE-438
10B	CTC-EE-439

RACK #	FUNCTION
11B	CTC-EE-440
12B	CTC-EE-447
13B	CTC-EE-448
14B	CTC-EE-488
15B	TBD
16B	TBD
17B	TBD
18B	TBD
19B	TBD
20B	TBD

**PRELIMINARY**  
DATE: 4/9/2010

RELEASE LEVEL: Conceptual  
DWG VERSION NO: proi-version

WELDING ENGINEER  
APPROVED: \_\_\_\_\_ DATE: \_\_\_\_\_

COMPUTER GENERATED DRAWING MANUAL CHANGES NOT PERMITTED Pro E DO NOT VERIFY INFORMATION BY SCALING DRAWING SCALE: 0.020 NEXT ASSEMBLY	CENTRAL FILES UNLESS OTHERWISE SPECIFIED DIMENSIONS ARE IN INCHES MACHINE SURFACES $\sqrt{R}$ BREAK SHARP EDGES: 0.0625/0.03125 TOLERANCES NON-CUMULATIVE DECIMAL-INCH FRACTIONS X ±0.00 01'-02" ±0.04 XX ±0.00 12'-02" ±0.16 XXX ±0.05 02'-10" ±0.14 ANGULAR ±07'-10" OVER 100' ±0.2	PRINCETON PLASMA PHYSICS LABORATORY PRINCETON UNIVERSITY NATIONAL SPHERICAL TORUS EXPERIMENT NSTX GENERAL ARRANGEMENT DUAL NB DIV: MECH. ENG. DATE: 8/17/2009 ENG: E.PERRY APPROVED: _____ DSN: J.MITCHELL CHK: _____	E-FA1048 SHEET OF 3 REV _____
--	---	--	----------------------------------

NSTX-E-FA1048

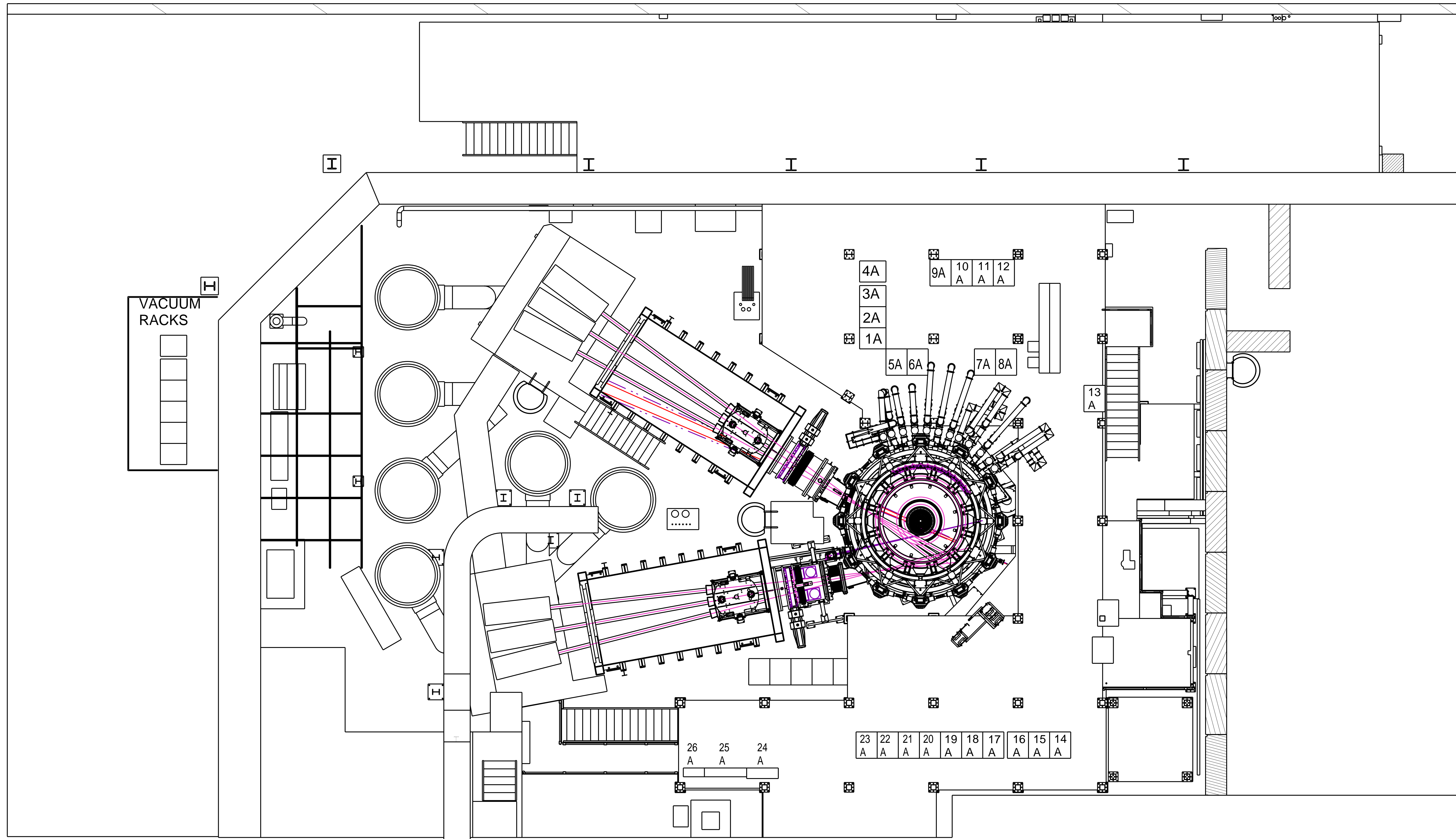

ELEVATION 109'-0"

RACK #	FUNCTION
1A	CTC-EE-415
2A	CTC-EE-414
3A	CTC-EE-413
4A	CTC-EE-423
5A	CTC-EE-416
6A	CTC-EE-417
7A	CTC-EE-420
8A	CTC-EE-424
9A	CTC-EE-412
10A	CTC-EE-411

RACK #	FUNCTION
11A	CTC-EE-410
12A	CTC-EE-421
13A	CTC-EE-446
14A	CTC-EE-496
15A	CTC-EE-479
16A	CTC-EE-480
17A	CTC-EE-481
18A	CTC-EE-482
19A	CTC-EE-483
20A	CTC-EE-484

RACK #	FUNCTION
21A	CTC-EE-485
22A	CTC-EE-486
23A	CTC-EE-487
24A	B-TOR-01B
25A	B-TOR-01
26A	B-TOR-01A
27A	TBD
28A	TBD
29A	TBD

**PRELIMINARY**  
DATE: 4/9/2010

RELEASE LEVEL: WIP  
DWG VERSION NO: -version

WELDING ENGINEER  
APP'D: \_\_\_\_\_ DATE: \_\_\_\_\_

COMPUTER GENERATED DRAWING MANUAL CHANGES NOT PERMITTED Pro E DO NOT VERIFY INFORMATION BY SCALING DRAWING SCALE: NEXT ASSEMBLY	CENTRAL FILES UNLESS OTHERWISE SPECIFIED DIMENSIONS ARE IN INCHES MACHINE SURFACES BREAK SHARP EDGES: 0.05/0.025 TOLERANCES NON-CUMULATIVE	PRINCETON PLASMA PHYSICS LABORATORY PRINCETON UNIVERSITY NSTX GENERAL ARRANGEMENT DUAL NB										
	<table border="1"> <tr> <td>DECIMAL-INCH</td> <td>FRACTIONS</td> </tr> <tr> <td>XX +.000</td> <td>01/32 1/16</td> </tr> <tr> <td>XXX +.000</td> <td>1/2" 3/16</td> </tr> <tr> <td>XXXX +.000</td> <td>1/2" 1/8</td> </tr> <tr> <td>ANGULAR</td> <td>05'-10" OVER 100' ±1/2</td> </tr> </table>	DECIMAL-INCH	FRACTIONS	XX +.000	01/32 1/16	XXX +.000	1/2" 3/16	XXXX +.000	1/2" 1/8	ANGULAR	05'-10" OVER 100' ±1/2	DIV: MECH. ENG. DATE: 6/17/2009 ENG: E.PERRY DSN: J.MITCHELL CHK: _____
DECIMAL-INCH	FRACTIONS											
XX +.000	01/32 1/16											
XXX +.000	1/2" 3/16											
XXXX +.000	1/2" 1/8											
ANGULAR	05'-10" OVER 100' ±1/2											

NSTX-E-FA1048

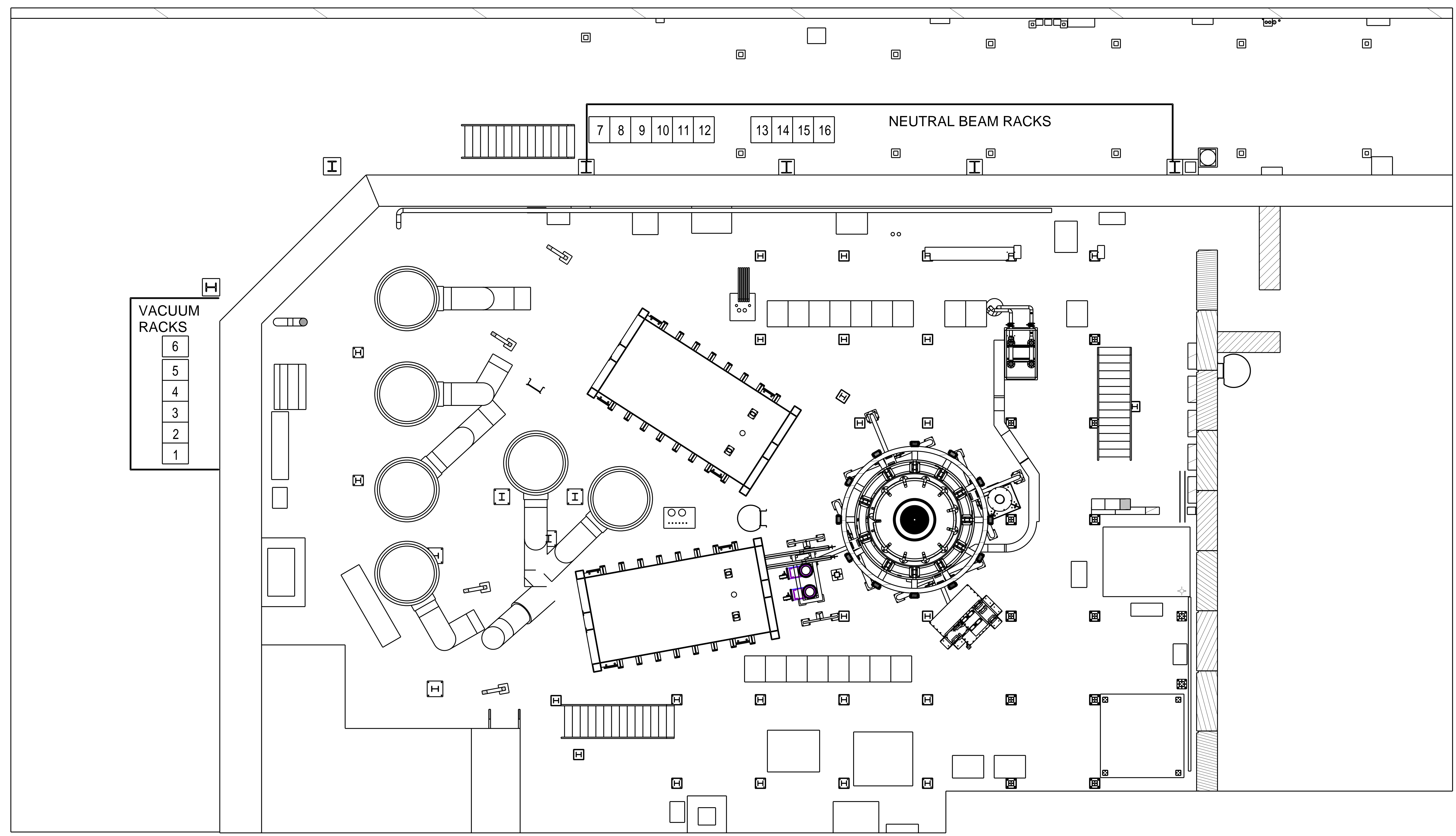

ELEVATION 100'-0"

RACK #	FUNCTION
1	CTC-EE-445
2	CTC-EE-444
3	CTC-EE-443
4	CTC-EE-442
5	CTC-EE-441
6	CTC-EE-449
7	CTC-EE-407
8	CTC-EE-406
9	CTC-EE-405
10	CTC-EE-404

RACK #	FUNCTION
11	CTC-EE-403
12	CTC-EE-402
13	CTC-EE-401
14	TBD
15	TBD
16	TBD
17	TBD
18	TBD
19	TBD
20	TBD

**PRELIMINARY**  
DATE: 4/9/2010

RELEASE LEVEL: Conceptual  
DWG VERSION NO: -version

WELDING ENGINEER  
APP'D: \_\_\_\_\_ DATE: \_\_\_\_\_

COMPUTER GENERATED DRAWING MANUAL CHANGES NOT PERMITTED Pro E DO NOT VERIFY INFORMATION BY SCALING DRAWING	CENTRAL FILES UNLESS OTHERWISE SPECIFIED DIMENSIONS ARE IN INCHES MACHINE SURFACES $\sqrt{R}$ BREAK SHARP EDGES: 0.0625/0.000	PRINCETON PLASMA PHYSICS LABORATORY PRINCETON UNIVERSITY NSTX GENERAL ARRANGEMENT DUAL NB	
	SCALE: NEXT ASSEMBLY	TOLERANCES NON-CUMULATIVE DECIMAL-INCH FRACTIONS X +.000 0/16 XX +.000 0/16 XXX +.005 0/16 ANGULAR 0/15 OVER 10/15	DIV: MECH. ENG. DATE: 01/17/2010 ENG: E.PERRY DSN: J.MITCHELL CHK: _____ APP'D: _____
		E-FA1048 SHEET 3 OF 3 REV _____	

NSTX-E-FA1048